

## TEST4ALL

Our **TEST4 ALL** system is a pioneering technology that automates the evaluation of inhibitor test results and sends the results to an app for documentation.

**TEST4 ALL** displays the results instantly and clearly for the microbial (reference) test Milk Test **MT EF4G SENSITIV**.

## VISUAL EVALUATION BY USING THE COLOUR SCALE OF THE MT EF4G SENSITIV MILK TEST

Examine the sample at the sides and the bottom of the tube to determine the colour. A light blue line is of no relevance for the evaluation.



## STORAGE

The test kit is stored at **5–16°C** to maintain its sensitivity for 12 months from the date of production, as specified in the product description on the product's shelf life. **Protect MT EF4G Sensitiv from freezing temperatures.** To the best of our knowledge, the information contained herein is accurate and complete. Nonetheless, none of the information contained herein should be construed as a guarantee. The test is standardised and each batch is tested under the conditions described. If these parameters are not observed to during testing, no guarantee can be given for accurate test results.

## MILK TEST DETECTION LIMITS

Substances	MRL	MILK TEST MT EF4G SENSITIV
<b>β-LACTAMS:</b>		
Amoxicillin	4	3
Ampicillin	4	3
Cephalexin	100	50
Cephapirin	60	5
Cephalonium	20	5
Ceftiofur	100	25
Cefazolin	50	25
Cefoperazone	50	25
Cefquinome	20	20 – 40
Cloxacillin	30	25
Oxacillin	30	15
<b>Naftillin</b>		
Penicillin G	4	2
<b>TETRACYCLINES:</b>		
Chlortetracycline	100	100
Doxycycline	–	100
Oxitetracycline	100	100
Tetracycline	100	100 – 125
<b>SULFONAMIDES:</b>		
Sulfadiazine	100	50
Sulfadimethoxine	100	75
Sulfametazine	100	100 – 125
Sulfamethoxypyridazine	100	75
Sulfathiazole	100	75
<b>MACROLIDES:</b>		
Erythromycin	40	80 – 100
Tylosin	50	40
<b>AMINOGLYCOSIDES:</b>		
DH-Streptomycin	200	800
Gentamycin	100	150
Neomycin	1 500	500
<b>LINCOSAMIDES:</b>		
Lincomycin	150	150 – 200

# MILK TEST MT EF4G SENSITIV

Inhibition test for all relevant antibiotics.  
Meets regulatory requirements under  
German law



05.11.24 | Version 2.2

Page 01 | 06

e ANALYTICS

E Analytics GmbH  
Westring 24, 48356 Nordwalde

+ 49 (0) 2573 / 977960  
info@e-analytics.de  
www.e-analytics.de

e ANALYTICS

## USE

The **MT EF4G** milk test is a microbial inhibitor test that detects all MRL-relevant antibiotics such as Beta-lactams, Tetracyclines, Macrolides, Aminoglycosides, Sulfonamides, Trimethoprim and other antibiotics. It is suitable for analysing cow, goat and sheep milk, including raw and heat-treated milk as well as milk powder. The **MT 25 EF4G Sensitiv** milk test was developed for milk producers. For large-scale dairy farms and milk processing companies, we offer the **MT 50 EF4G Sensitiv** and **MT 100 EF4G Sensitiv** ampoule tests.

The inhibitor test **MT EF4G Sensitiv** Milk Test meets the latest requirements of dairies which call for the highest level of sensitivity. We are happy to provide the detection limits of the antibiotics for comparison upon request.

## INSTRUCTIONS USING THE PIPETTE

Please do not use any other pipette than the clean pipette that is supplied with the kit.

- 1 Squeeze the rubber bulb and release it to aspirate the sample. The pipette fills with liquid; any excessive milk is drawn into the overflow tank of the pipette.
- 2 The aspiration tube now contains the required volume of 100 µl. Squeeze the bulb again to ensure accurate dosing. The excessive liquid remains in the overflow tank.

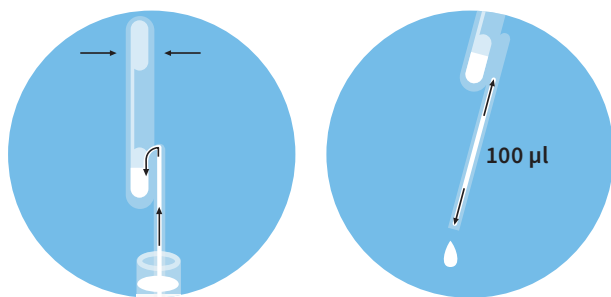

## INSTRUCTIONS PREPARING THE MILK SAMPLE

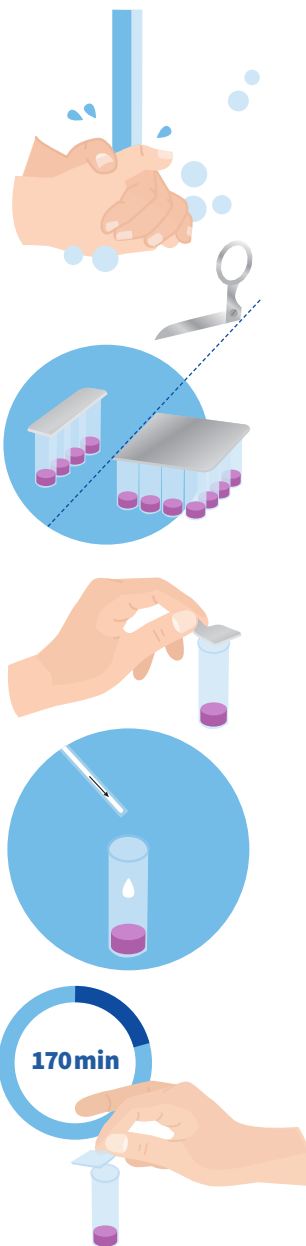

- 1 Always store the test tubes upright in the original package and keep it refrigerated at approx. 8°C (protected from light).
- 2 Wash your hands with soap before testing. Make sure the work top is clean! Preheat the incubator.
- 3 Take a pair of scissors and cut off the desired number of test tubes. Do not tear them off! This may damage the foil so that the remaining tubes dry out.
- 4 Label the tubes to identify the individual samples.  
Take a pointed and sterile stick and pierce the foil or pull the foil off the tube.
- 5 Dispense the milk sample in the pipette into the tube (following the instructions on the left). Use a fresh pipette for each sample!
- 6 Close the test tubes using the foil supplied or an adhesive tape and incubate the sample for 170 minutes.

## SUITABLE ANALYSERS INCUBATORS FOR THE MT EF4G SENSITIV MILK TEST



### MT DIGITAL

**65° C +/- 0.5° C, 10 holes, timer, digital display**

As temperature and incubation time are important parameters in inhibitor screening, these heating blocks are ideal for maintaining these parameters.

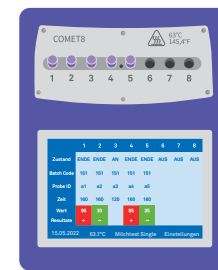

### COMET8

**63° C +/- 0.5° C, 8 holes, timer, digital touch screen, Wi-Fi-capable, compatible with the TEST4 ALL app**

**Comet8** carries out inhibitor tests automatically. The device can be controlled from your smartphone. Monitor the process in real time and have the results automatically sent to your smartphone / PC.



### COMET4

**63° C +/- 0.5° C, practical tester with 4 holes, WIFI-capable, compatible with the TEST4 ALL app**

The **COMET4** connects to your smartphone via Bluetooth and allows you to start a screening from the **TEST4 ALL app**. **COMET4** sends the results to your smartphone and saves them to an external server. You can view the results immediately in your account at the **TEST4 ALL** website.